



IMPORTANT WARRANTY & INSTALLATION
INSTRUCTIONS ATTACHED

*Please Forward All Attached Information to Consumer
Warranty Not Valid Unless Returned to CORSA Performance*

We ask that you take a few moments to complete our warranty registration form:

TO ACTIVATE YOUR LIMITED LIFETIME WARRANTY GO TO:
CORSAPERFORMANCE.COM/WARRANTY



**For Full-Color Installation Instructions, Please Visit:
CORSAPERFORMANCE.COM and Search by Part Number**

Please be sure to review the enclosed instructions prior to beginning the installation process. If you have any questions about the enclosed parts, instructions or encounter a problem during installation:
CALL CORSA PERFORMANCE TECHNICAL ASSISTANCE AT 800.486.0999

Please take time to read and understand these installation instructions.

CORSA recommends that the installation of this system be performed by a qualified service center or professional muffler installer who has the necessary equipment, tools and experienced personnel. However, if you decide to perform this install, the use of a hoist and an additional person will be required.

CAUTION: Never work on a hot exhaust system. Allow time for the vehicle to cool. Always wear eye protection when working under a vehicle.

Recommended Tools:

- 3/8" drive ratchet
- 3/8" drive 13mm deep socket
- 3/8" drive 15mm deep socket
- 3/8" drive 12" ratchet extension
- Small, flat head screw driver
- Chain style pipe cutter
- Grommet pullers
- Spare tire removal kit
- Soap and water solution
- Torque wrench
- Safety glasses

Please confirm that all parts are present according to the bill of materials before beginning the installation.

If something is missing call Tech Support at 1- 800-486-0999

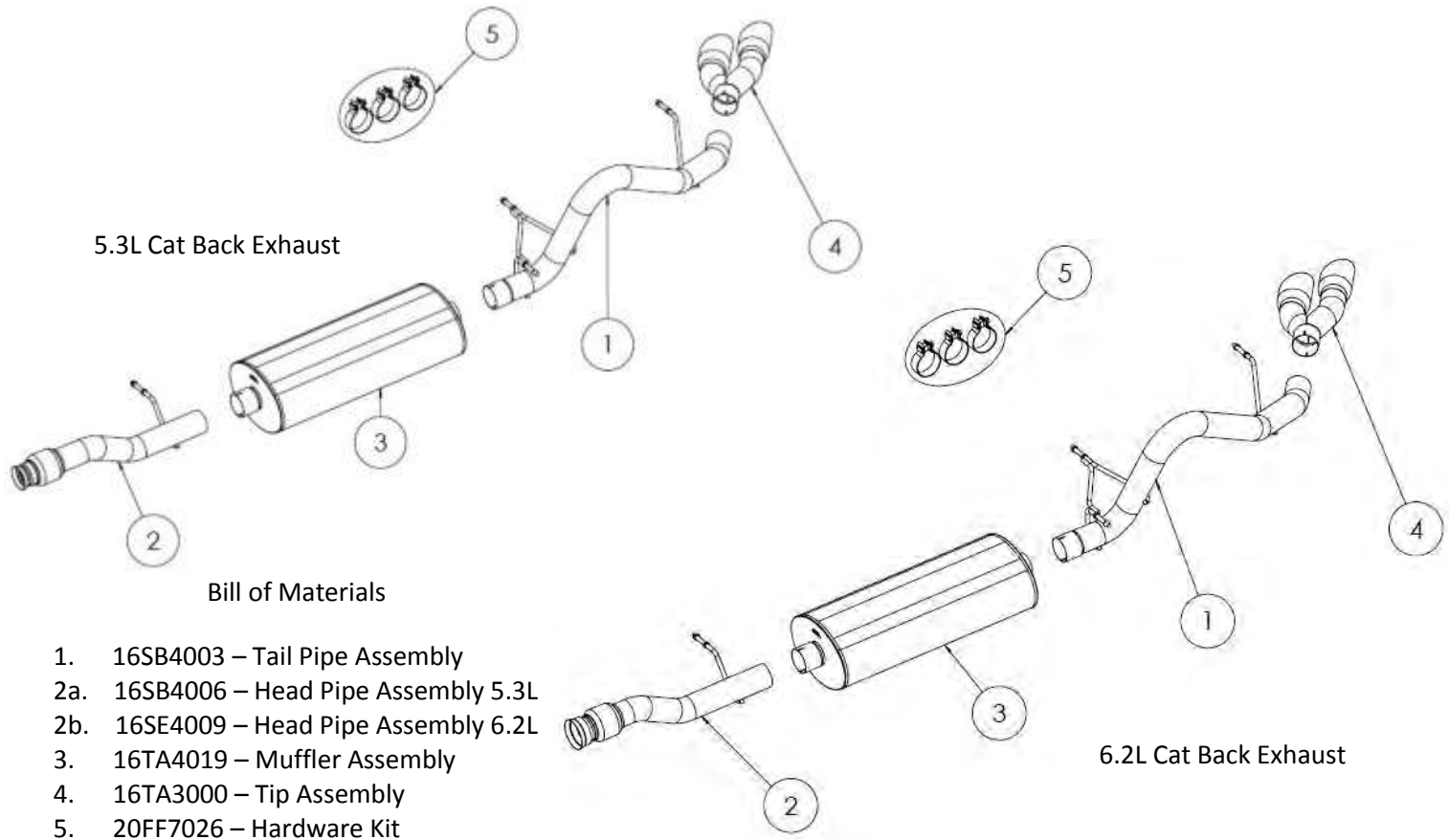

Factory Exhaust System Removal:

1. Lower or remove the spare tire from the vehicle. Refer to the Owner's Manual for how to do this on your specific vehicle.
2. Loosen the spherical clamp at the front of the exhaust using 13mm socket and ratchet. **(Fig. A)**
Note: The use of a penetrating lubricant spray may make this step easier.
3. Support the rear of the tunnel muffler using a jack stand or similar device. Place a chain style cutter around the tail pipe about 1-2" behind the muffler on the front half of the axle pipe. Cut the tail pipe at this location. **(Fig. B)**
Caution: The muffler is only supported by the jack stand and the hanger at this time. Take care as to not let it fall and damage the vehicle or cause injury.
4. Remove the grommet from the head pipe hanger using grommet pullers or a similar device. **(Fig. C)** Remove this section of the exhaust from the vehicle.
Note: Using a soapy solution on the grommet holes will make the job easier.
5. Using a small, flat head screw driver, gently pry up on the tab holding the clamp to the head pipe. Retain this spherical clamp for use during Corsa exhaust installation. **(Fig. D)**
6. Using the ratchet, 15mm socket, and 12" extension as needed, remove the two 15mm bolts securing the spare tire heat shield. Retain the bolts and heat shield for reinstallation later. **(Fig. E)**
7. Using grommet pullets or a similar device, remove the three hangers from the grommets supporting the tail pipe. Remove the tail pipe from the vehicle by gently guiding it towards the rear of the vehicle, over the rear axle.
Note: Using a soapy solution on the grommet holes will make the job easier.
8. This concludes the factory exhaust removal process.

REMOVAL PICTURES ON NEXT PAGE 

Factory Exhaust Removal Pictures



Fig. A



Fig. B



Fig. C



Fig. D



Fig. E

REMOVAL PICTURES CONTINUED ON NEXT PAGE 

Installation of CORSA Exhaust System:

NOTE: Apply the anti-seize lubricant (*supplied*) to the threads **ONLY** of all the clamps and flange bolts. Failure to follow this procedure can cause nuts to seize on clamps and potentially destroy threads. After applying anti-seize lubricant, be sure to thoroughly clean your hands, as lubricant will tarnish stainless steel. All clamps should be tightened using a properly calibrated Torque Wrench. Using an air impact gun will damage the clamp and reduce its ability to effectively seal the joint. It may also cause the joint to separate, thereby causing damage to your exhaust system and to your vehicle.

NOTE: Align all clamps so that the center of the clamp bolt is 90 degrees from the notch in the pipe. (See Fig. CLAMP)

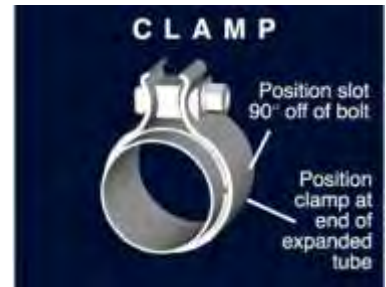

1. Remove all system components from the shipping box, including the clamps.
2. From the front side of the vehicle, carefully guide the CORSA tail pipe over the axle towards the rear, passing the hanger through the voids in the spring. Install each hanger into the factory grommets. (Fig. F, G, & H)
Note: Using a soapy solution on the grommet holes will make the job easier.
3. Locate the CORSA head pipe assembly and the factory spherical joint retained from the removal process. Rotate the head pipe until the hanger shoulder is parallel to the ground, then snug the clamp at the spherical connection using a 13 mm socket and ratchet. (Fig. J & K)
Note: Using a soapy solution on the grommet hole will make the job easier.
4. Slide a supplied 3" TORCA clamp over the inlet of the CORSA muffler. Make sure the muffler is oriented so the drain hole is facing down, then slide the muffler onto the head pipe and snugly tighten the clamp with a 15mm socket and ratchet. (Fig. L & M)
5. Slide a supplied 3" TORCA clamp over the inlet of the CORSA tail pipe. Slide the tail pipe on to the muffler and snugly tighten the clamp with a 15mm socket and ratchet. (Fig. N)
6. Slide a 3" TORCA clamp over the tip assembly inlet, and place the tip onto the end of the tail pipe. Adjust assembly inlet on tail pipe so that tips match bevel of the rear quarter panel. Rotate the tip assembly until tips have equal clearance to the side of the rear bumper cover. Adjust and rotate the tail pipe as necessary to align tip as desired. Snugly tighten the clamp at this time using a 15mm socket and ratchet. (Fig. P & Q)
7. Adjust all CORSA components to attain clearance to surrounding parts. Starting from the front of the CORSA exhaust system, tighten all TORCA clamps to 45 ft-lbs and all spherical clamps to 21 ft-lbs using a torque wrench.
8. Reinstall the heat shield using a 15mm socket and ratchet. Replace the spare tire to pre-removal condition (refer to Owner's Manual if necessary), and replace the lock and cover plate in the rear bumper. (Fig. R)
It is strongly suggested that all clamps be checked and tightened after road testing the vehicle, once the system has cooled.



Cat Back Exhaust System

2015+ Chevrolet Suburban 5.3L

2015+ GMC Yukon XL & Yukon Denali 6.2L

Single Side Exit w/ Twin 4.0" Pro-Series Tip

PN 14748, 14748BLK, 14749 & 14749BLK

NOTE: During cold weather start-ups, you may experience an exhaust sound that is deeper and louder in tone than usual. This is temporary and will diminish to normal levels once your engine has reached its normal operating temperature.

NOTE: Immediately following the installation of your exhaust system, you may experience a trace of smoke after initial start-up. DO NOT be alarmed. The smoke is caused by the burning of a small amount of forming oil residue used in the manufacturing process.

INSTALLATION PICTURES ON NEXT PAGE 

CORSA Exhaust Installation Pictures



Fig. F



Fig. G



Fig. H



Fig. J



Fig. K



Fig. L

INSTALLATION PICTURES CONTINUED ON NEXT PAGE 

CORSA Exhaust Installation Pictures:



Fig. M



Fig. N



Fig. P



Fig. Q



Fig. R